



African Continental Resources cc



T & D FITTINGS CATALOGUE 2025

The Views, Founders Hill Office Park
18 Centenary Way, Founders Hill
2065

Tel : +27 11 608 1126 | Fax : +27 11 608 3313
info@acr.x.africa | www.acr.x.africa

36th
Anniversary
1989-2025



ABOUT US

Overview:

Founded in 1989, ACR has established itself as a leading supplier and distributor of power line accessories and electrical products. With over three decades of industry experience, we have built a reputation for excellence, reliability, and innovation in the electrical supply sector.

Our Mission:

At ACR, our mission is to provide high-quality electrical solutions that empower utility companies, contractors, and industries to operate efficiently and safely. We are dedicated to delivering superior products and exceptional service to all our clients.

Product Range:

Power Line Accessories: We offer a comprehensive range of connectors, insulators, and protective equipment designed to enhance the reliability and safety of power distribution networks.

Electrical Products: We supply a variety of essential electrical components, including cables, transformers, and switches, tailored to meet the diverse needs of our customers.

Customer-Centric Approach:

At ACR, we believe in building long-term partnerships with our clients. Our dedicated team of professionals is committed to understanding the unique needs of each customer and providing tailored solutions that drive their success. We take pride in our responsive customer service and technical support, ensuring that our clients have access to the expertise they need.

Sustainability Commitment:

We recognize the importance of sustainability in today's world. ACR is dedicated to promoting environmentally responsible practices within the electrical supply industry. We actively seek innovative products and solutions that contribute to energy efficiency and conservation.

Quality Assurance:

We prioritize quality in every aspect of our business. Our products are sourced from reputable manufacturers and undergo rigorous testing to ensure they comply with industry standards and regulations. Our commitment to quality ensures that our clients receive only the best.

Conclusion:

With a proven track record of excellence, ACR is your trusted partner for power line accessories and electrical products. Our professional and knowledgeable team is here to support your projects and ensure you have the resources needed for success.

For more information about our products and services, please visit our website or contact our customer support team. We look forward to serving you.

LV ABC LINE HARDWARE



Strain Clamp

- Available for Insulated & Bare Neutral ABC.
- For Neutral Sizes 35, 55 & 70mm².
- Breaking load 1500kg.



Strain Clamp Assembly

- Available for Insulated & Bare Neutral ABC.
- For Neutral Sizes 35, 55 & 70mm².
- Supplied with CS mounting bracket.



Suspension Clamp

- Available for Insulated & Bare Neutral ABC.
- For Neutral Sizes 35, 55 & 70mm².
- UV resistant body and latch.



Suspension Clamp Assembly

- Available for Insulated & Bare Neutral.
- For Neutral Sizes 35, 55 & 70mm².
- Supplied with CS mounting bracket.



Airdac Strain Clamp

- LV service connections for round cables.
- Available in 4mm², 10mm² & 16mm².
- UV Resistant body.



Airdac Suspension Clamp

- LV service connections for round cables.
- Available in 4mm², 10mm² & 16mm².
- UV Resistant body.



Dead End Clamp 2 x 16-35

- UV Resistant body.
- Suitable for 16, 25 & 35mm² x 2 Core.
- Breaking load 250kg.



House Service Strain Clamp

- Suitable for 2 x 16 & 2 x 25 or 4 x 16 & 4-25.
- UV Resistant body.
- Breaking load 210kg.



German Strain Clamp

- Suitable for 4 x 25mm² to 4 x 120mm².
- Use with M16 eye bolt.
- Used on self supporting 4-core cable.

LV ABC LINE HARDWARE



German Suspension Clamp

- Suitable for 4 x 25mm² to 4 x 120mm².
- Use with M16 pigtail bolt.
- Used on self supporting 4-core cable.



LV Suspension Strap

- Suitable for 4 x 25mm² to 4 x 120mm².
- Use with M16 pigtail bolt.
- Used on self supporting 4-core cable.



Insulation Piercing Connector (IN)

- Suitable for 16-95, 4-35, 25-95 & 35-150mm².
- Available in single & double bolt versions.
- Tapping into Insulated Al-Al or Al-Cu.



Insulation Piercing Connector (BN)

- Suitable for 16-95, 4-35mm².
- Available in single bolt only.
- Tapping into bare neutral Al-Al or Al-Cu.

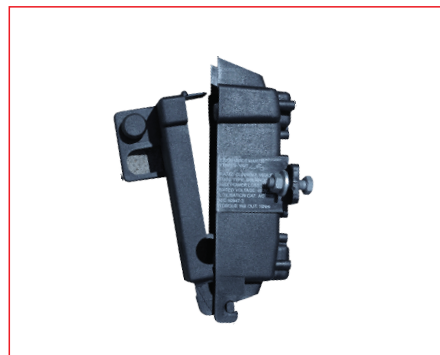

LV Fuse Switch Mosdorf

- Available in single, dual, and three-phase units.
- Compatible with NH00 fuses, 63-160 amps.
- Comes with a Pilot Light.



Fuse NH00 Mosdorfer

- Used in the LV Fuse Switch.
- Amp rated 63, 80, 100, 125, 160 amps.

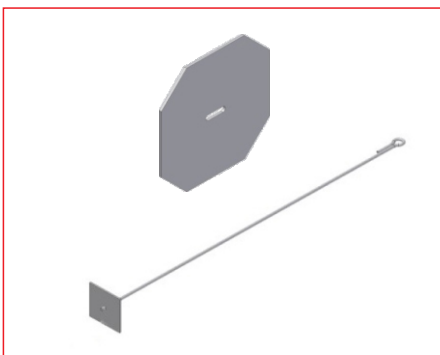

Non-Adjustable Stay Kit

- Stay rods M12 X 1.5m & M20 X 2m.
- Base plates 300x300 & 375 x 340.
- Hot-dipped galvanised.



Stay Insulator LV

- To be used with an LV stay kit assembly.
- Tensile Load: 45kN.
- All tolerances are according to IEC 60383.



Guy Grip Dead End

- For stay wire sizes 3/3.35 - 19/4.00.
- Pre-Formed, Galvanised Steel.
- Used as a fitting in the stay kit assembly.

STEEL & ALUMINIUM LINE HARDWARE

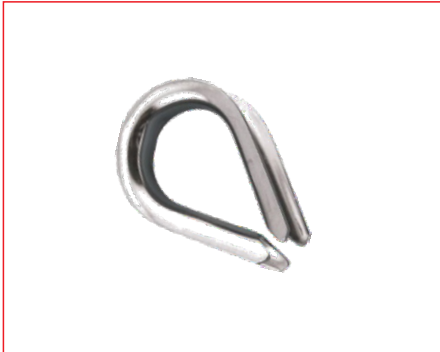

Wire Rope Thimble

- To fit 14 mm diameter steel wire.
- Use with the M16 pigtail bolt.
- Used as a fitting in the stay kit assembly.

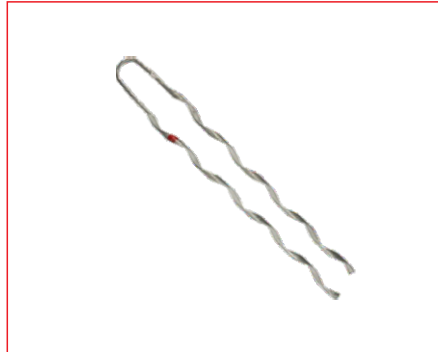

Galvanised Steel Pole Top

- For stay wire sizes 3/3.35 - 19/4.00.
- Pre-Formed, Galvanised Steel.
- Used as a fitting in the stay kit assembly.



Galvanised Steel Side Tie

- Suitable for AL & ACSR Conductors.
- Pre-Formed, Galvanised Steel.
- Used with the Line Post Insulator.

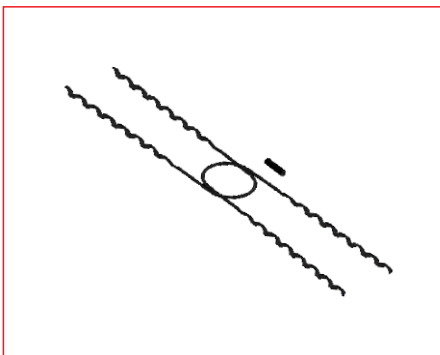

Aluminium Twin Tie

- Suitable for AL & ACSR Conductors.
- Pre-Formed, Aluminium.
- Used with the Line Post Insulator.

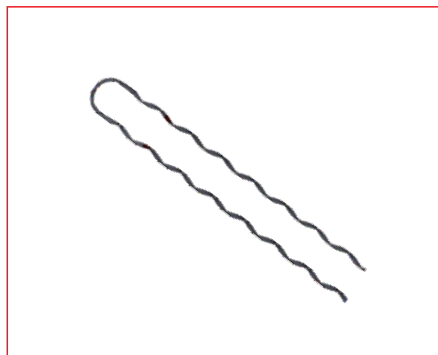

Aluminium Alloy Dead End

- Suitable for AL & ACSR Conductors.
- Pre-Formed, Aluminium.
- Used with the Silicone Long Rod Insulator.



Aluminium Alloy Armor Rod

- Suitable for AL & ACSR Conductors.
- Pre-Formed, Aluminium.
- Used with the Cradle Suspension Clamp



Pigtail Bolt Assembly

- Sizes: M10x280, M12x340, and M16x380.
- Supplied as an assembly with Nuts and Washers.
- Hot-dip galvanised.



Eye Bolt

- Sizes: M16x250, M20x250, and M20x350.
- Supplied as an assembly with Nuts and Washers.
- Hot-dip galvanised.



Eye Nut

- Sizes: M12, M16, and M20.
- Hot-dip galvanised.
- Used with the Eye Bolt and Threaded Rod.

STEEL & ALUMINIUM LINE HARDWARE



Spindles

- Supplied in M20x50, M20x250, and M20x300.
- Hot-dip galvanised, Standard and Ratchet.
- Supplied as an assembly with nuts and washers.



Crosby Clamp

- Sizes: M12, M16, and M20.
- Hot-dip galvanised.



Threaded Rod Assembly

- Supplied sizes from M6x500 to M20x1000.
- Hot-dip galvanised.
- Supplied as an assembly with nuts and washers.



D-Shackle

- Drop-forged steel.
- Available in 70 kN, 120 kN, and 210 kN.
- Used with the Silicone Long Rod Insulator.



Stay Strap 45deg

- Rated at 96 kN.
- Hot-dip galvanised.
- Used as a part of the stay assembly.

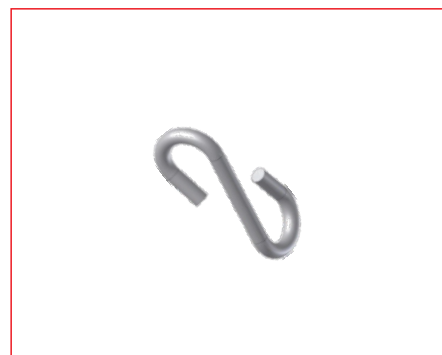

Twisted S Hook

- Twisted M10.
- Hot dip galvanised.



Pole Top Bracket

- Hot-dip galvanised.
- Used with the Line Post Insulator.



Thimble Clevis

- Rated at 40 kN, 70 kN & 120 kN.
- Aluminium Alloy.
- Used with the Line Post Insulator.



L - Bracket / Question Mark

- Available as curve and straight types.
- Hot-dip galvanised.
- Used for mounting of Arresters and Cutouts.

STEEL & ALUMINIUM LINE HARDWARE



Strut Pole Bracket

- Available for LV and MV
- Hot-dip galvanised.
- Used as an alternative to the Stay Kit.



PG Clamp

- Supplied in 1-bolt, 2-bolt, and 3-bolt versions.
- Available in Aluminium & Bimetal.
- Size range from 3 mm to 22 mm.



Ball Clevis

- Rated at 120 kN.
- Body: forged steel, hot-dip galvanised.
- Used with the Silicone Long Rod Insulator.



Socket Tongue

- Rated at 120kN.
- Malleable cast iron, hot-dip galvanised.
- Used with the Silicone Long Rod Insulator.



Twisted Clevis-Tongue

- Rated at 120 kN.
- Body: forged steel, hot-dip galvanised.
- Used with the Silicone Long Rod Insulator.



Socket Clevis

- Rated at 120 kN.
- Body: forged steel, hot-dip galvanised.
- Used with the Silicone Long Rod Insulator.



Pistol Grip / Strain Clamp

- Rated at 40 kN, 70 kN and 120 kN.
- Available in Aluminium & Cast Iron.
- Size range from 4 mm to 40 mm.



Cradle Suspension Clamp

- Available in Aluminium & Cast Iron.
- Size range from 5 mm to 40 mm.
- Used with Pre-Formed Armor Rods.



Line Tap

- Tin-plated.
- Size range from 4 mm to 150 mm.

INSULATORS



Line Post Insulator - Capped

- Range from 11 kV to 44 kV.
- Creepage from 300 mm to 1120 mm.
- Material: Porcelain with a metal cap.



Line Post Insulator - Capless

- Range from 11 kV to 33 kV.
- Creepage from 400 mm to 1120 mm.
- Material: Porcelain without a metal cap.



Silicone Long Rod Insulator

- Range from 11 kV to 132 kV.
- Creepage from 402 mm to 4495 mm.
- Material: Silicone, Clevis Tongue, or Ball Socket.



Silicone Line Post Insulator

- Range from 11 kV to 36 kV.
- Creepage up to 1120 mm.
- Material: Silicone.



Stand Off Insulator

- Range from 66 kV to 132 kV.
- Creepage up to 4495 mm.
- Material: Silicone.



MV Stay Insulator

- To be used with an MV stay kit assembly.
- Tensile Load: 96 kN.
- All tolerances are according to IEC 60383.



Guy Strain Insulator

- To be used with an MV stay kit assembly.
- Tensile strength 97 kN.
- Silicone-coated fiberglass rod and ductile.



Station Post Insulator

- Rated at 4 kN to 10 kN.
- Range from 11 kV to 132 kV.
- Used in Substations.



Shackle / Reel Insulators

- For use on systems up to 1000 V.
- Material: Porcelain.

MV LINE HARDWARE



Distribution Class Surge Arrester

- Range from 3 kV to 36 kV.
- Rated at 10 kA.
- Material: Silicone.



Station Class Surge Arrester

- Range from 3 kV to 132 kV.
- Available in Porcelain and Silicone.
- Used in Substations.



Drop Out, Fuse Cut Out, Porcelain

- Range from 3 kV to 36 kV.
- Material: Porcelain.
- Base + Fuse Carrier supplied as a complete unit.



Drop Out, Fuse Cut Out, Silicone

- Range from 12 kV to 36 kV.
- Material: Silicone.
- Base + Fuse Carrier supplied as a complete unit.



Fuse Cut Out, Load Break

- Range from 12 kV to 36 kV.
- Material: Porcelain.
- Base + Fuse Carrier supplied as a complete unit.

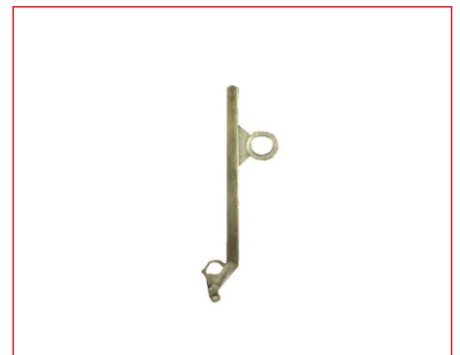

Solid Brass Link

- Range from 12 kV to 36 kV.
- Material: Brass.
- Continuous Current: ≤ 200 Amp.

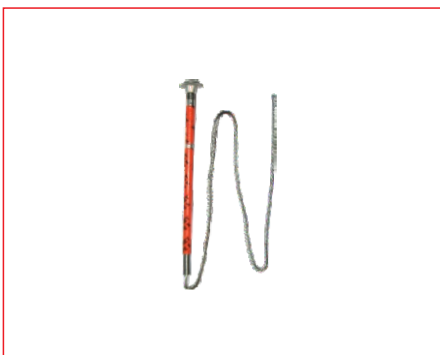

Fuse Link

- Range 1 Amp - 125 Amps.
- Tail Length: 788 mm.
- Used with the Drop-Out Fuse Cutout.



Earth Rod / Earth Spike

- Size range from 1.2 m to 3 m.
- Material: Copper-cladded.
- Supplied as M16 without an earth clamp.



Earth Rod Clamp

- To be used on an M16 earth rod.
- Material: Solid Brass.

LUGS & FERRULES



Lug Pre Insulated - Bimetal

- Rated up to 1000 Volts, for ABC LV.
- Available sizes from 16 mm to 150 mm.
- Connecting ABC Cables to transformers.



Joint Pre Insulated

- Rated up to 1000 Volts, for ABC LV.
- Available sizes from 16 mm to 150 mm.
- Used for joining ABC Cables.



Lug AL Round

- Range includes LV and MV.
- Available sizes from 16 mm - 630 mm.
- Suitable for Hex Crimping.



Ferrule AL Round

- Range includes LV and MV.
- Available sizes from 16 mm - 630 mm.
- Suitable for Hex Crimping.



Lug Bimetal

- Available sizes from 16 mm - 630 mm.
- Material: Aluminium and Copper.
- Suitable for Hex Crimping.



Ferrule Bimetal

- Available sizes from 16 mm - 630 mm.
- Material: Aluminium and Copper.
- Suitable for Hex Crimping.



Lug Shear Head

- Available sizes from 16 mm to 1000 mm.
- Material: Aluminium Alloy, surface tin-plated.
- Available with Tinned Brass and AL Shear Bolts.



Ferrule Shear Head

- Available sizes from 16 mm to 1000 mm.
- Material: Aluminium Alloy, surface tin-plated.
- Available with Tinned Brass and AL Shear Bolts.



Cu Lugs & Ferrules

- Available sizes from 16 mm - 630 mm.
- Material: tin-plated copper.
- Suitable for Hex Crimping.

INSTALLATION TOOLS



Comealong Clamp

- Available sizes from 4 mm - 38 mm.
- Suitable for AL, CU, Steel and ABC.
- Jaw: Smooth, Serrated, Oval and Knurled.
- Rated from 1 Ton to 6 Tons.

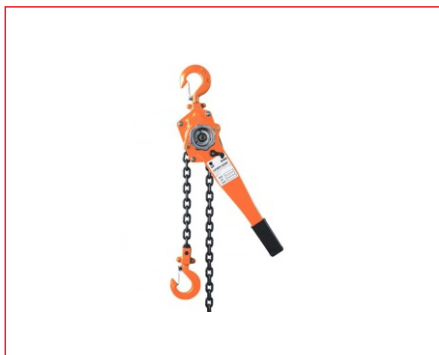

Lever Hoist

- Supplied with a 3m chain.
- Rated from 0.75 Ton to 6 Tons.

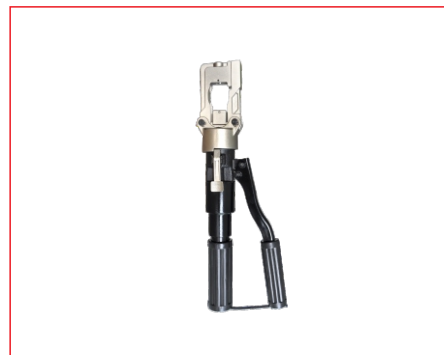

Hydraulic Crimping Tools - HEX

- Crimping size range from 6 mm to 500 mm.
- Suitable for AL, CU and ABC.
- Supplied complete a with carry case & dies.



Hydraulic Crimping Tool 4PI

- Crimping size range from 10 mm - 240 mm.
- Suitable for aluminum versa crimp fittings.
- Dieless crimper supplied with a carry case.

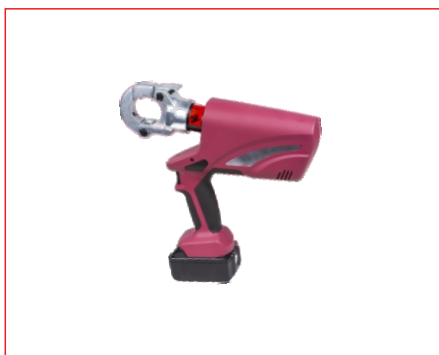

Battery Powered Crimping Tool

- Crimping size range from 6 mm - 500 mm.
- Suitable for AL, CU and ACSR.
- Carry case, battery, charger and dies included.



Hydraulic Cable Cutter

- Cutting range from 45 mm to 85 mm diameter.
- Suitable for AL, CU and ACSR.
- Carry case Included.



Battery Powered Cable Cutter

- Cutting range from 45 mm to 85mm diameter.
- Suitable for AL, CU and ACSR.
- Carry case, battery and charger included.

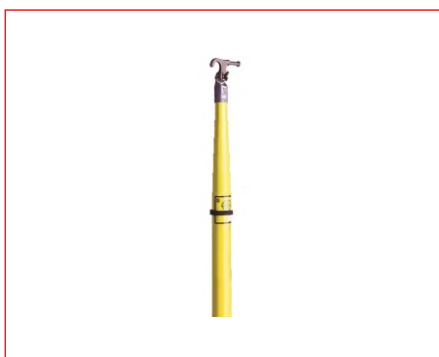

Telescopic Link Stick

- Rated at 132 kV per foot.
- Sizes 4 m to 12 m.
- Available in round and tri-angular.

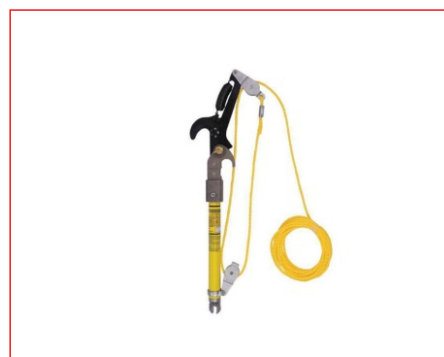

Universal Three Pruner

- A Universal saw can be attached to the head.
- Drop-forged steel blades.

INSTALLATION TOOLS

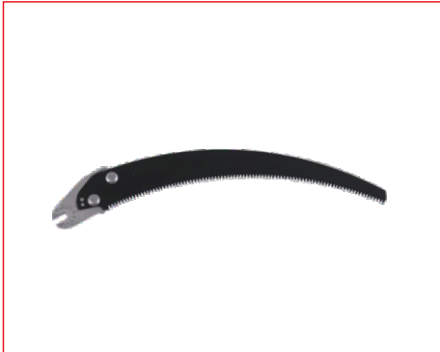

Universal Pruning Saw

- Adapts to all tools with universal heads.
- Can be used as a hand saw.
- High-quality curved blade.



Handline c/w Block & Rope

- Working load limit 450 kg.
- Working Height: Up to 9 m.
- Rope Length: 18 m.



Insulating Gloves / Protectors

- Available from Class 0 to Class 4.
- Rated from 1000 Volt to 33 kV.
- Size range from 7 to 12.



Linesman Safety Belt

- Padded kidney support.
- One size fits all.
- Easy to operate and easy to remove.

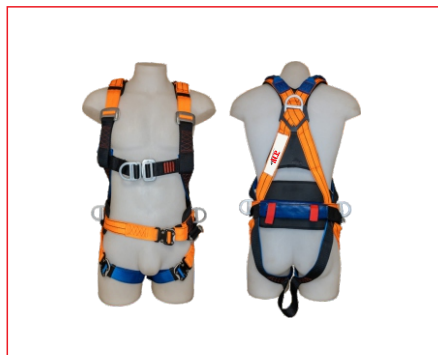

Linesman Safety Harness

- Full-body harness with aluminium hardware.
- Padded kidney support.
- Complete with accessories and a carry bag.



Running Out Block / Pulley

- Available for ABC LV, MV, and ACSR.
- Material: Steel frame with an Aluminium wheel.
- Used for installation of powerline cables.



Strapping Tool

- Tightening and securing S/Steel strapping.
- Suitable for heavy-duty applications.



Pole Climbing Shoes

- Leather straps included.
- Load compatible up to 150 kg.
- Used by linemen when climbing wood poles.



Earth Sets

- Available in Red (Control) and Yellow (Working).
- Rated 11 to 33 kV.
- Supplied complete in a bag, excluding the link stick.

SOLAR, INVERTERS AND MORE



Pole Top Box

- For pole-top metering and distribution.
- Manufactured from high quality material.



Steel U Cross Arm

- Hot dipped galvanised
- Range from 1.3 M to 3 M.

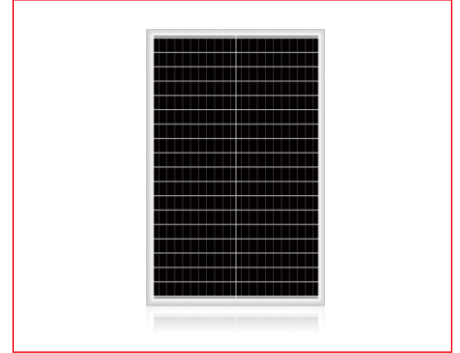

Solar PV Modules

- For Residential and Commercial Use.
- Range from 20 W to 695 W.
- 25-Years Warranty.

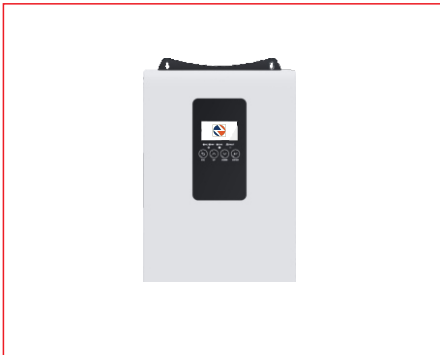

Single-Phase Hybrid Inverter

- For Residential Use.
- Range from 1.2 kW to 5 kW.
- A variety of intelligent working modes.



Single-Phase Hybrid Inverter

- For Residential Use.
- Range from 3 kW to 8 kW.
- Remote monitoring via APP or Web.



Three-Phase Hybrid Inverter

- For Residential and Commercial Use.
- Range from 20 kW to 60 kW.
- 5-Year Warranty.



LED Solar Street Light - Phil

- LED: 30W to 120W.
- Achieve cost efficiency and energy reduction.
- Solar Panel and Battery Included.



LED Solar Street Light - Phoenix

- LED: 40W to 100W.
- Mitigating Urban Lighting's Environmental Impact.
- Solar Panel and Battery Included.



LED Solar Street Light - Speccraft

- LED: 40W to 100W.
- Reliable Illumination in Any Weather Conditions.
- Solar Panel and Battery Included.

CABLE ACCESSORIES & MORE

Auto Reclosers

CKMR Reclosers:

- Available in voltage classes 15.5, 27 & 38 kV
- Single-phase (15.5 kV) or three-phase (up to 38 kV)



Separable Connectors

IEEE/ANSI & IEC Std. Connectors:

- Elbows, bushing insert, bushing well.
- Junctions.
- Elbow arresters.



Jumper Links

- Chardon jumpers are prefabricated lengths of cable on which separable connectors or terminations are installed on each end.
- Ideal for wind turbines, transformers, or as test leads.



CABLE ACCESSORIES & MORE



Transformer Components

Other accessories for transformers and related equipment include bushing wells for safe, removable elbow connections, and bayonet fuse holders that provide overcurrent protection with hotstick operability for quick, reliable replacement in oil-filled systems.



Cold Shrink Terminations and Joints

Cold Shrink Terminations & Splices:

- Available in 15, 25 & 35 kV voltage classes
- For indoor and outdoor use.
- Tested and manufactured in compliance with ANSI/IEEE and IEC standards.

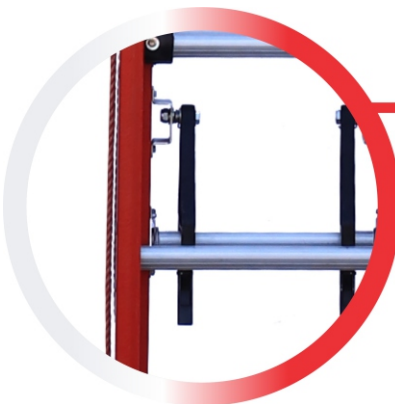

Fiberglass Ladders

- Two sets of high-strength steel guides.
- Type 1A fiberglass extension model 580.
- These ladders are lightweight yet sturdy.
- Feature 'D' shaped rungs
- Spring assisted heavy duty nylon gravity rung locks.



Contact Us

The Views, Founders Hill Office Park
18 Centenary Way, Founders Hill
2065

Tel : +27 11 608 1126 | Fax : +27 11 608 3313
info@acr.africa | www.acr.africa